



How to read the T-Card

Depending on the type of card, the face for reading will differ.
When reading the wrong side, there will be reading error.

*In case reading error appears, enter the membership number directly.

Bring the [◀] to the front facing the user and insert the card in the direction of the [▶]

T-Card with credit card function
General card without the T-design

Read the [front face]

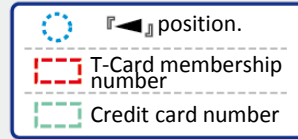
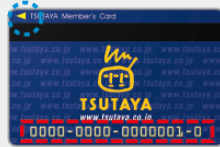
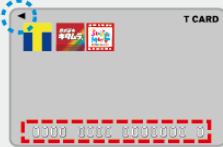
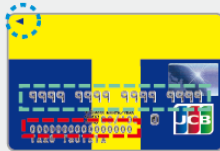

* Make sure to enter the T Card number and not the credit card number.

General card with T-design

Read the [back face]

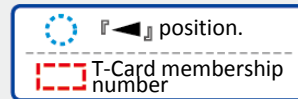

* There are design varieties other than above.

For inquiries

Inquiries for T-Point Service
(Various applications, changes and etc.)

Inquiries for usage of terminal machine,
Y!-Room and operation failures

How to switch on the power

Long press the [power switch] on the terminal (about 3 seconds).

? To free the sleep mode, press the [power button].



How to shut off the power

Long press the [power switch] on the terminal (about 3 seconds) and indication of [tablet option] will appear.

How to attach the card reader

Connect the attachment to the ear phone plug, than fix the card reader onto the attachment.

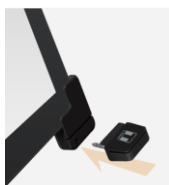

How to start the application

Touch the [T-UNIT] icon on the home screen.



1

How to read the T-Card

Start the application to show the T-Card reader screen.

Read the T-Card.

Confirm the T-Card reading method on Page 1 for correct reading.

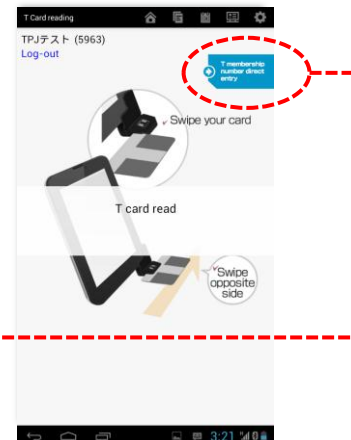

? If T Card can not be read, directly enter the membership number.

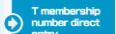
Touch the  sign on the top right of the screen.

T Membership number direct enter screen will appear on the display.

Directly enter the 9 digit number on the T-Card or the 16 digit T-Card membership number using the numeric keypad.

If the number is correct, touch the  key.

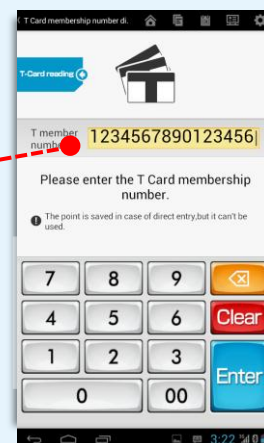

***Points can be added but can not be used with direct entry.**

2 Enter transaction information

When T-Card reading is complete, the screen on the right will appear.

① Enter amount of payment

Use the numeric keypad to enter the amount of payment and touch the key.



② Setting the multiplying number of the adding points

In order to change the multiplying number of the adding points, touch and set the X times number.

Adding points will be calculated automatically.



③ Entering amount of points to use

When using points

Use the numeric keypad to enter the amount of points to use and touch the key.

When not using points

Confirm that points used is [0 points] and touch the key.



3 Confirm entered information

Information that has been entered will appear on the screen.

If the information is correct, touch the key.

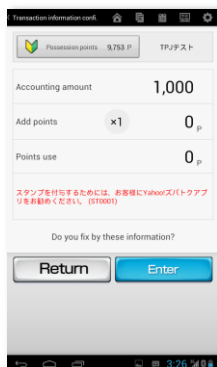

4 Point receipt display

When transaction is complete, point receipt will show on the screen.

When going back to the T Card reading screen, touch key.



1 List of payment details

T-Card reader screen will appear.

Touch on top right of screen.

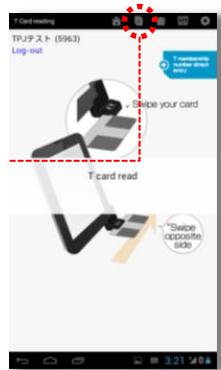

2 Select payment detail

Details will show in the order of recent use.

Touch the desired delete detail.

If detail is not found

Touch for search.

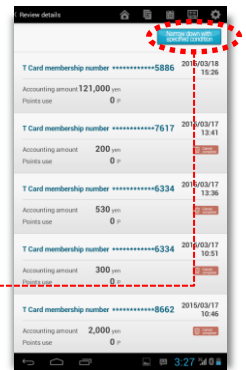

3 Cancellation

Details of payment will appear on the screen.

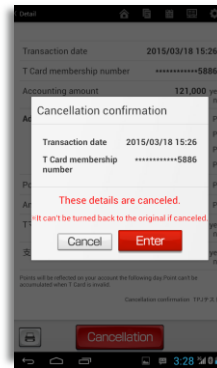
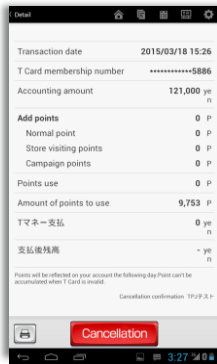

Touch key and cancel confirmation will appear.

If the information is correct, Touch key.

4 Receipt

sign will appear on the top right of payment details screen.

When going back to the T-Card reading screen, touch on top right of screen.

